

NEW VEHICLE ON ORDER!

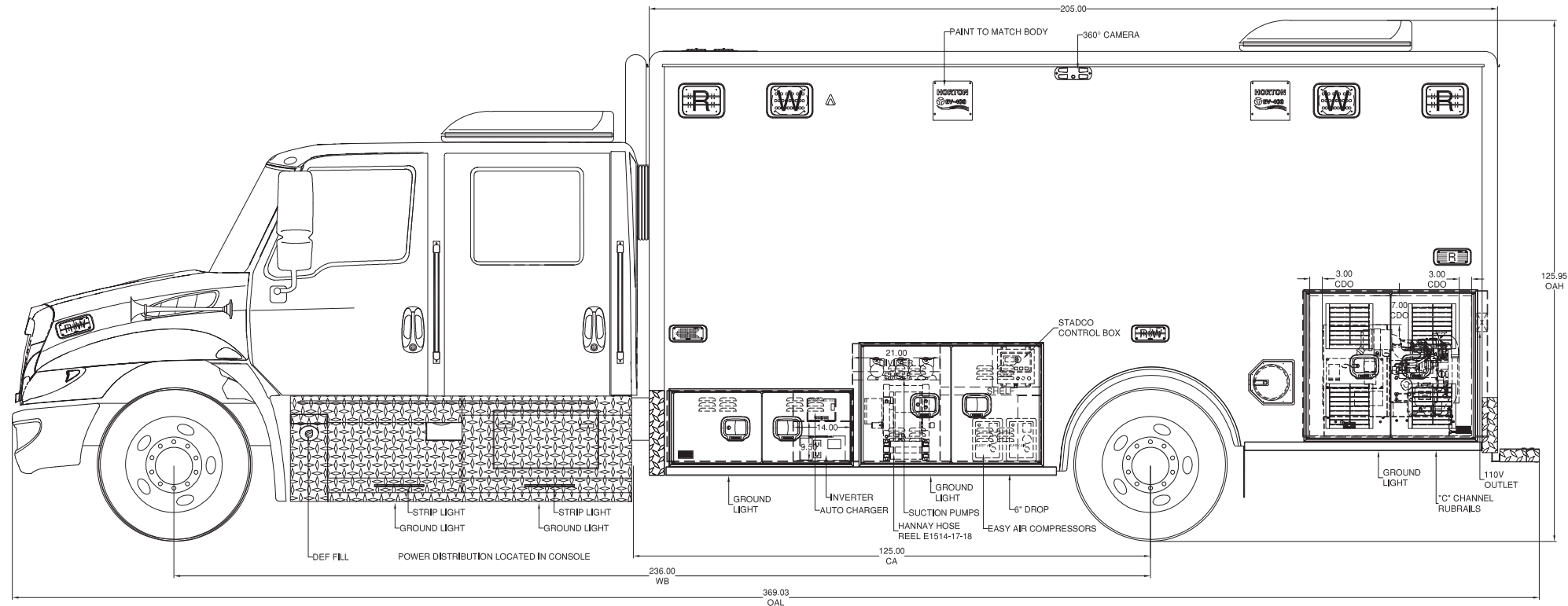

This unit was sold by Chuck Simpson.

**CONGRATULATIONS, CHILDREN'S HOSPITAL OF THE KINGS DAUGHTERS!
HORTON MODEL #CCT / NICU UNIT - PRODUCTION #20086**

2022 INTERNATIONAL MV

**CCT / NICU LAYOUT TRANSPORTS (2) PATIENTS VIA COTS OR INCUBATORS
HEAD OF BODY CURBSIDE FORWARD DOOR FOR TRANSVERSE COT & STANDARD LOCATION COT
CUSTOM HIGH-BACK SEATING ON BOTH WALLS
SUCTION & OXYGEN CONTROL SYSTEMS WITH DUAL REAR PANELS
CAPABLE OF PRODUCING MEDICAL GRADE AIR THROUGH STANDALONE MEDICAL AIR SYSTEM**

ORDER